



Handheld Quick Start Guide

Aarcomm's Handheld Quick Start Guide provides support for the following items, included in your Aarcomm Handheld remote control system:

- Aarcomm handheld
- C220/C200 Receiver
- Antenna
- Universal Charging Cradle
- Wiring Harness



POWERING ON THE HANDHELD

The Aarcomm handheld requires a special sequence to turn on to ensure all buttons are working correctly prior to start up, and minimize any accidental powering up of the Handheld.

To power up the Aarcomm handheld:

- Press and hold the **RED BUTTON**
- Press and hold the **GREEN BUTTON**
- Release the **RED BUTTON**
- Release the **GREEN BUTTON**

Regular flashing **GREEN LED**:
System turned on but no link.

Solid, or short flashes of **GREEN LED**:
System turned on and linked.

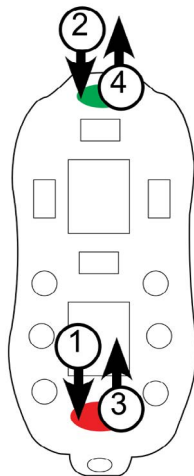

MATCHING INSTRUCTIONS

To successfully pair a handheld with a receiver, both devices need to enter matching mode within a 60-second timeframe. The receiver offers two different methods to activate matching mode, while the handheld has one method available.

FIRST METHOD

1. Turn off the Aarcomm handheld.
2. Apply power to the C220.

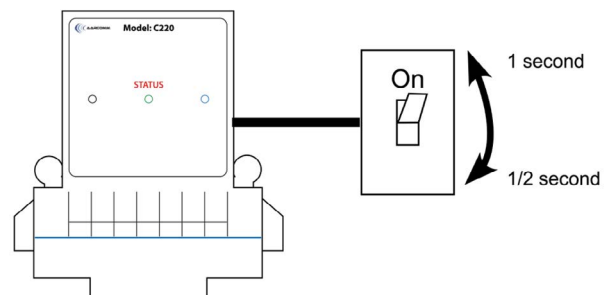

3. Momentarily ("blip") the power off to the C220 six to seven times (i.e. power off for 1/2 second, power on for one second; six times). Leave the power on after the sixth blip.
4. The LED on the C220 will light up **DARK BLUE**.
5. Continue with steps five to eight below in second method.

SECOND METHOD

1. Turn off the Aarcomm handheld.
2. Apply power to the C220.
3. Using a smooth motion, wave the handheld back and forth over the top left corner of the C220 so that the two magnets under the **RED BUTTON** and **GREEN BUTTON** pass over the surface of the Aarcomm logo.

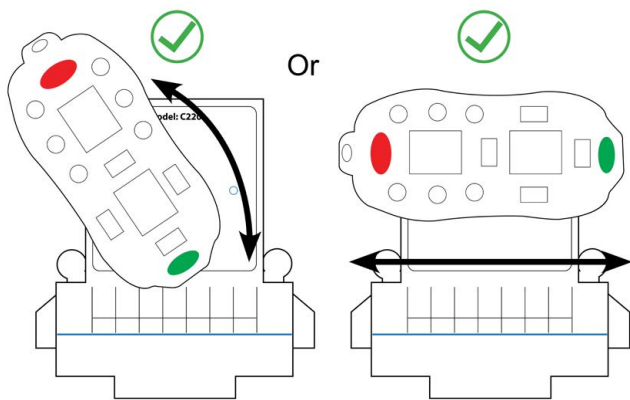

4. If the C220 successfully detects the magnets on the handheld, the C220 LED will light up **DARK BLUE**.
5. Press and hold the three round buttons on the bottom left side of the handheld.
6. Press and release the **RED BUTTON** on the handheld.
7. The C220 LED will turn white and a message will appear on the handheld indicating a successful match. If not, make sure the handheld and the C220 have compatible part numbers.
8. Power on the handheld normally to verify that the system is matched.

POWERING OFF THE HHT HANDHELD

Press the **RED E-Stop BUTTON** to shut down the Aarcomm hand-

held. The LCDs on the handheld will go into sleep mode and will not draw any power from the battery.

C220 & C200 RECEIVER MOUNTING

The C200 and C220 receivers are designed to withstand water and have an impressive IP67 rating. For optimal performance, it is recommended to select a mounting location that offers protection from both weather conditions and excessive vibration.

C220 WIRE HARNESS INSTALLATION

The C200 receiver is equipped with a customized wire harness designed specifically for your machine. It is crucial to ensure proper installation by fully inserting both connectors into the bottom of the C200 receiver and securely fastening them with the latches, thus ensuring optimal functionality and compatibility.

ANTENNA INSTALLATION

The mounting location should be chosen such that the C220 and C200 receiver antennas have the best possible line of sight with the Aarcomm handheld in order to maximize the operating range. The standard antenna mount provided is an NMO type. It requires a 3/4" hole.

- When installing with a hole saw, remove any burrs, particularly on the under side of the hole.
- Remove paint in a narrow ring around the hole.
- Metal-to-metal contact between the vehicle and the mount is essential for best performance.
- An optional L-bracket can also be supplied if it is not possible to cut a 3/4" hole on the mounting surface.

Make sure the gold contact on the mount is clean before attaching the antenna.

For proper antenna contact, the supplied rubber gasket is required for metal thicknesses ranging from 0.030" to 0.050". The gasket is not required for thicknesses from 0.050" to 0.100".

TECHNICAL SUPPORT:

1.604.265.8500

1.800.604.9218

SUPPORT@AARCOMM.COM

AARCOMM